

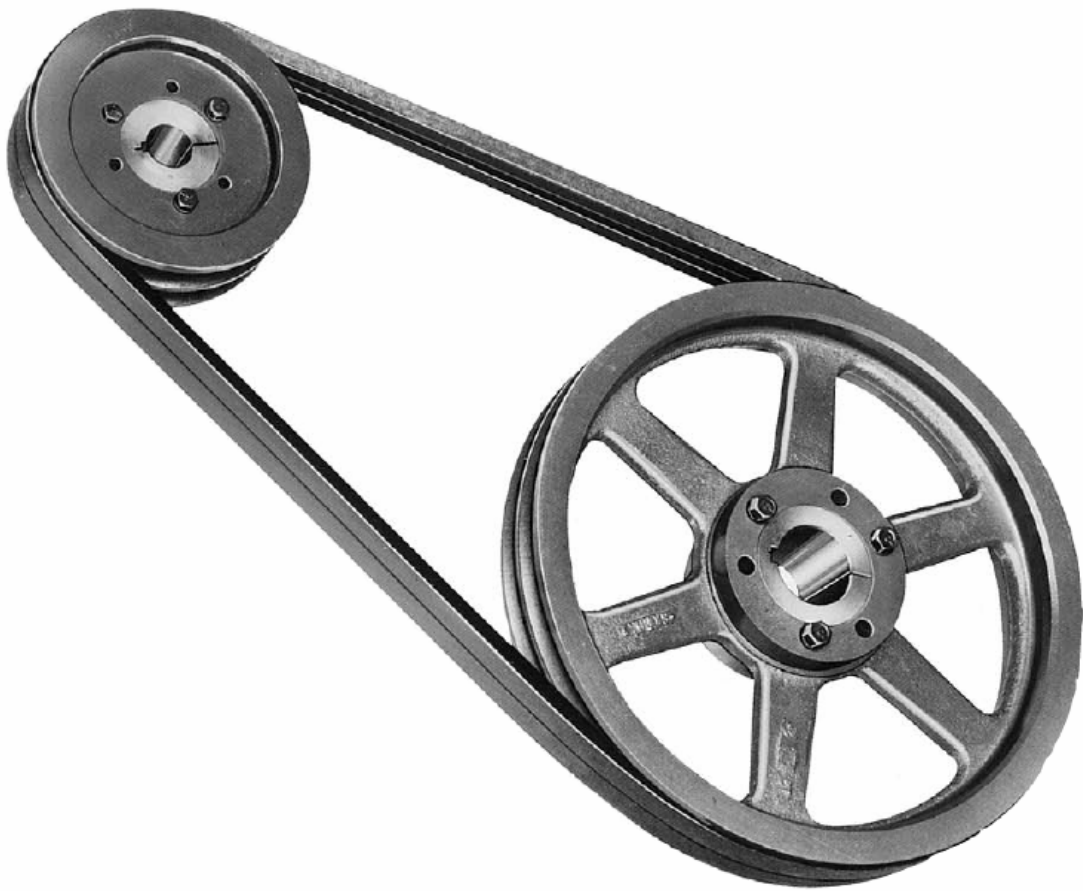

**Sheaves / Bushings / Belts**



## SHEAVES



### Drive : TW-25

Dimensions ( Inches )

Location	Datum Dia.	O.D.	I.D.	3 GROOVE – B SECTION						
				F = 2-1/2						
				E*	Type	Bush.	K	L	M	Wt.
<b>Motor</b>	5.0	5.35	3.62	7/16	A1	SD	1-1/16	1-13/16	1/4	8.10
<b>Drive</b>	20.0	20.35	18.50	1/16	D3	SF	5/8	2	9/16	45.70

\* "E" Dimension varies according to shaft tolerance.  
 Weights for all above are approximate and include the bushing.  
 P.D. for "B" Belts = DD + .413

### Drive : TW-50

Dimensions ( Inches )

Location	Datum Dia.	O.D.	I.D.	3 GROOVE – C SECTION						
				F = 2-1/2						
				E*	Type	Bush.	K	L	M	Wt.
<b>Motor</b>	5.0	5.40	3.25	7/16	A1	SD	1-1/16	1-13/16	1-1/8	9.70
<b>Drive</b>	30.0	30.40	28.18	1/4	C3	F	13/16	3-5/8	0	129.10

\* "E" Dimension varies according to shaft tolerance.  
 Weights for all above are approximate and include the bushing.  
 P.D. for "C" Belts is the same as diameter.

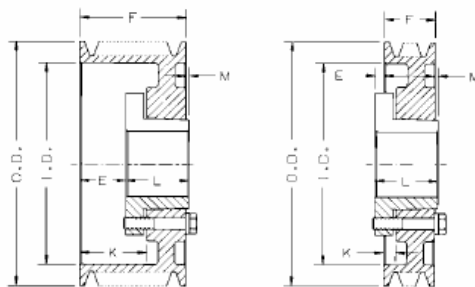

**Type B**

**Type C**

## BUSHINGS



### Torque Ratings & Dimensions

Bush	Torque Capacity (In-Lbs.)	Note 1 Max. Bore	Note 2 Max Bore	Dimensions In Inches						Bolt Circle	Cap Screws Required
				A	B	D	E	F*	L		
<b>SD</b>	5,000	1-15/16	42	7/16	2.1875	3-3/16	1-3/8	1-1/4	1-13/16	2-11/16	3-1/4 x 1-7/8
<b>SF</b>	11,000	2-15/16	63	1/2	3.125	4-5/8	1-1/2	1-1/4	2	3-7/8	3-3/8 x 2
<b>F</b>	40,000	3-15/16	90	13/16	4.4375	6-5/8	2-13/16	2-1/2	3-5/8	5-5/8	3-9/16 x 3-5/8

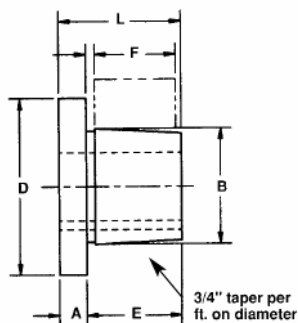

### Bore & Key Seat Dimensions

Bushing Type	Bore	Key Seat	*WT
( Inches )			
<b>SD ( TW-25 Motor )</b>	1-5/8	3/8 x 3/16	<b>1.2</b>
<b>F ( TW-50 Motor )</b>	2-1/2	5/8 x 5/16	<b>13.9</b>
<b>SF ( TW-50 Drive )</b>	2-1/4	1/2 x 1/4	<b>3.1</b>
( Metric )			
<b>SF ( TW-25 Drive )</b>	55	16 x 10	<b>3.2</b>

\* Approximate Weight in Lbs.

## BANDED V-BELTS

### BANDED V-BELT FEATURES

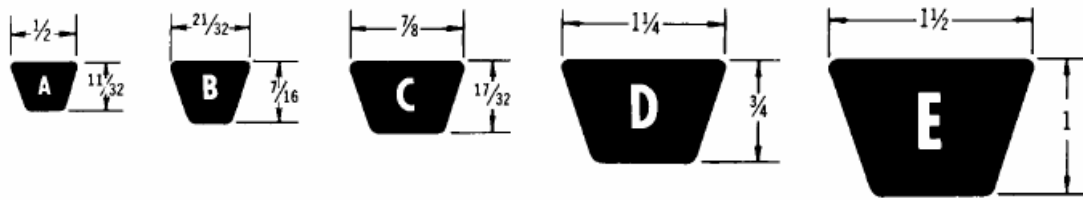

**Banded V-belts** are the finest wrapped belts in industry and are designed to provide premium performance at standard prices. The belts have a specially constructed cover fabric for optimum flexibility and abrasion resistant characteristics. Belts perform their best when operating on sheave diameters no smaller than RMA/MPTA recommended: A = 3.0, B = 5.4, C = 9.0, D = 13.0, and E = 21.6.

**Banded V-belts** have all the same features as a standard wrapped belt, but with the added benefit of multiple belts in a single belt. Should be considered for those problem drives where long center distance, vibration, pulsating or shock loads cause individual belts to whip, turn over, or jump out of sheave grooves. B and C belts available in 2 thru 5 ribs and D belts available in 3 thru 5 ribs.

The Banded V-Belts used with both the TW-25 & TW-50 *Twister* Drive Assemblies are 3 Rib Banded Belts.



### BANDED V-BELTS

Size	Datum Length	Weight Lbs.
<b>3RB96 ( B Section ) ( TW-25 Drive )</b>	97.8	3.9
<b>3RC96 ( C Section ) ( TW-50 Drive )</b>	98.9	6.6